



57 Kimbolton Road

Baffins, Portsmouth, PO3 6BZ

Offers in the region of £280,000



57 Kimbolton Road

Baffins, Portsmouth, PO3 6BZ

Offers in the region of £280,000



This charming and spacious family home in the heart of Baffins, Portsmouth, is an absolute must-see. With its stylish interior, versatile living spaces, and delightful outdoor area, this property has everything you need to create a warm and welcoming home.

As you step inside, you're greeted by a fabulous open-plan lounge, beautifully decorated in modern tones. The room boasts a feature fireplace and offers plenty of space to accommodate your favorite furniture and more, making it the perfect place to relax and unwind with family or entertain guests. There is a range of built-in under-stairs storage.

The lounge seamlessly flows into the bright kitchen-dining area, which has been thoughtfully updated with a brand-new kitchen installed just two years ago. Designed with both functionality and aesthetics in mind, this space is ideal for hosting dinner parties, family gatherings, or casual meals. Its generous size and contemporary feel make it a standout feature of the home.

Upstairs, the property offers two spacious double bedrooms and a well-proportioned single bedroom. Whether you need an additional bedroom, a study, a nursery, or a games room, this home caters to all your lifestyle needs. The upper floor also includes a fitted family bathroom, which is a white suite comprising a bath with shower over, WC and wash hand basin, ensuring convenience and comfort for everyone.

The outdoor space is equally impressive, featuring a good-sized garden that is perfect for summer enjoyment. With a patio area for al fresco dining and a section of low-maintenance artificial grass, this garden

is ideal for hosting barbecues, playing with the kids, or simply soaking up the sunshine.

Located in the sought-after area of Baffins, this property is close to local schools, amenities, and transport links, making it perfect for families and professionals alike.

Homes like this are selling fast, so don't miss out on the opportunity to make this stunning property yours. Call us today to arrange a viewing or email us for more details. Your dream home awaits!



Road Map

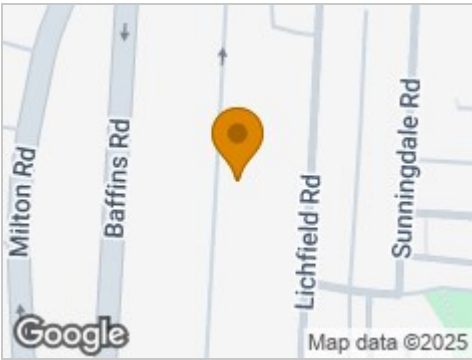

Hybrid Map



Terrain Map



Floor Plan

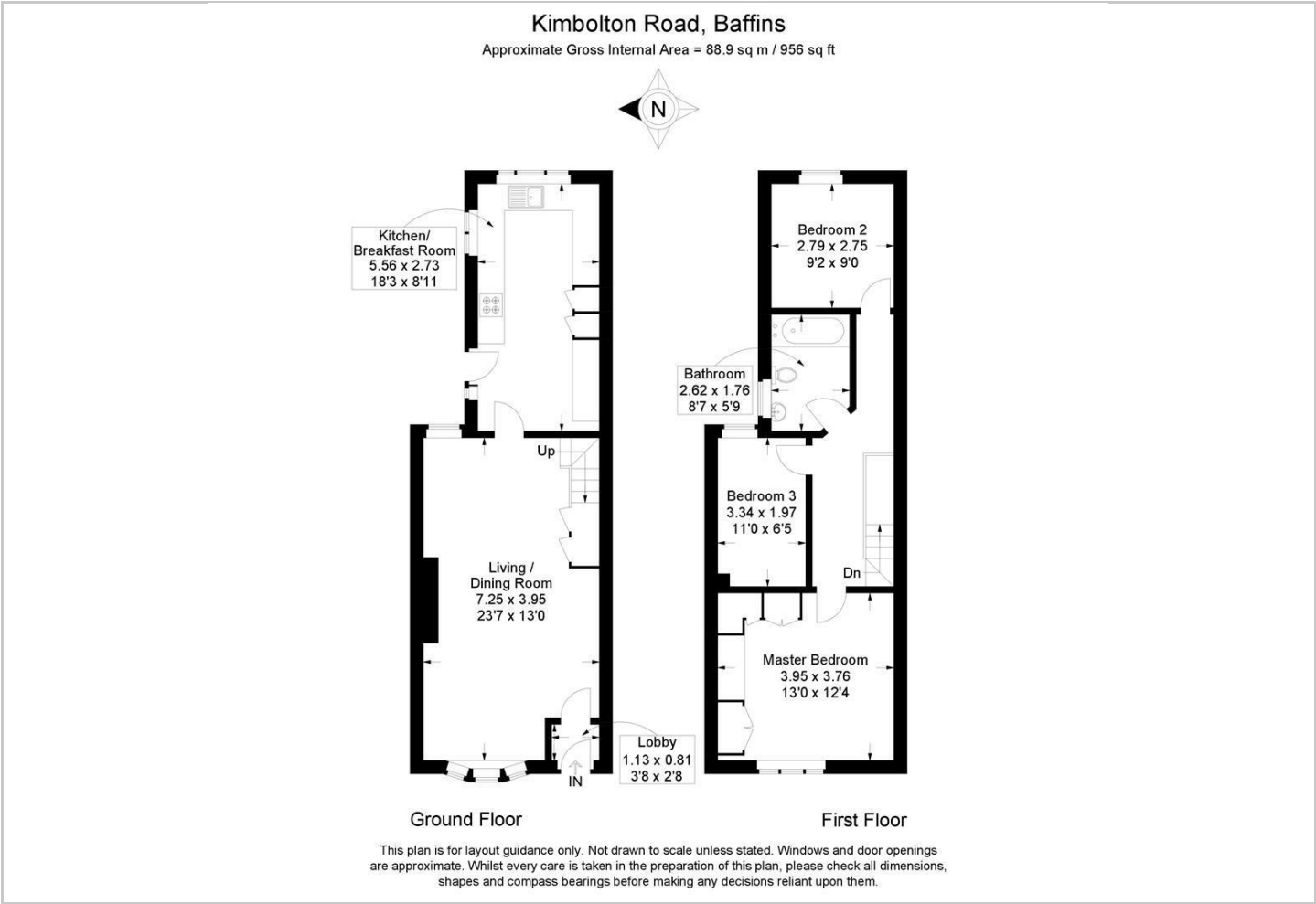

Viewing

Please contact our Central Office on 02394 217317 if you wish to arrange a viewing appointment for this property or require further information.

Energy Efficiency Graph



These particulars, whilst believed to be accurate are set out as a general outline only for guidance and do not constitute any part of an offer or contract. Intending purchasers should not rely on them as statements of representation of fact, but must satisfy themselves by inspection or otherwise as to their accuracy. No person in this firms employment has the authority to make or give any representation or warranty in respect of the property.